

# BASO 1.5 WALL WASH



## Catalog Number Example

BASO 1.5-RTL-WH-WW-30K-C80-UNV-010V-SEN-0400LF-NLC-ST-24IN-CCEA

### PERFORMANCE

- Up to 103lm/W efficiency
- 400 / 600 / 800lm/ft
- CRI > 80 & CRI > 90
- IC & Damp rated

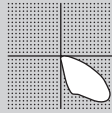

### MOUNTING

Recessed



### PATTERNS



Angular

Rectangular

For customization, please contact customer service

### BEAM DISTRIBUTION



<b>Wall to ceiling ratio</b>	
Room height	H = 9 ft
Distance to wall	A = 3 ft
Reflection factor	0.7   0.5   0.2
Maintenance factor	0.8
Eye level	4 - 5 ft

[link to page](#)

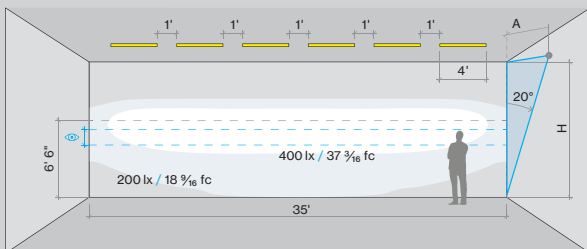

### A RANGE

BASO 1.5      BASO 1.5

### B MOUNTING

Recessed trimless	RTL
Recessed with trim	RTL
Armstrong Suprafine 9/16" G	A 9 G
Armstrong Interlude 9/16" SG	A 9 S
Armstrong Silhouette 9/16" BSG	A 9 S
Armstrong Prelude 15/16" G	A 1 5
9/16" Grid (any brand)	9 GR
9/16" Slot Grid (any brand)	9 SG
15/16" Grid (any brand)	1 5 G
Custom	XXX

### C COLOR

White	WH
Black	BL
Gray	GR
Custom color RAL	XX

trimless version available in white only

### D LENS

Asymmetric wall washer      WW

### E CCT

2700K	2 7 K
3000K	3 0 K
3500K	3 5 K
4000K	4 0 K

### F CRI

CRI > 80	C 8 0
CRI > 90	C 9 0

### G VOLTAGE

120V / 277V      UNV

### H DIMMING

0-10V 1%	0 1 0 V
Lutron EcoSystem	LES 1
Quantum, Vive, GRAFIK Eye, HomeWorks	
Power over ethernet	POE C
consult customer service for compatibility	
Custom dimming	XXX X
consult customer service for compatibility	

### I SENSOR (optional)

Integrated Sensor      SEN  
consult customer service for sensor request

### J OUTPUT LM/FT

400lm/ft 100% ±	0 4 0 0 L F
600lm/ft 100% ±	0 6 0 0 L F
800lm/ft 100% ±	0 8 0 0 L F
Custom lm/ft	XXX X L F

custom lumen up to 800 lm/ft

### K CIRCUIT / EM

Single circuit	*
EMC night light circuit	NLC
EMB available in 4ft and 8ft	EM #

\* leave blank

### L SHAPE / PATTERN

Linear / straight	ST
L-shape inner	LI
L-shape outer	LO
□-shape inner	RI
□-shape outer	RO
U-shape inner	UI
U-shape outer	UO
custom shape	XX

please contact customer service for availability

### M DIMENSIONS IN INCH

Linear 2'	2 4 I N
Linear 4'	4 8 I N
Linear 6'	7 2 I N
Linear 8'	9 6 I N
Linear custom	### I N
L-Shape	### X ### I N
U-Shape	### X ### X ### I N
□-Shape	### X ### I N

### N CERTIFICATION (optional)

Chicago Plenum	CCEA
Red List Approved	RLA

**BASO**  
basolighting.com  
xalusa.com

Technical data

	SIZE TYPE	LED COLOR TEMPERATURE	INPUT WATTS	DELIVERED LM TOTAL	LIGHT DISTRIBUTION	DELIVERED LM DIRECT	OPTICAL EFFICIENCY	LUMINAIRE EFFICACY
<b>BASO DIRECT</b>								
e LED	4' linear	30K, 35K, 40K	16W	1600lm	100% down	400lm/ft	67%	103lm/W
	8' linear		32W	3200lm				
e <sup>2</sup> LED	4' linear	30K, 35K, 40K	24W	2400lm	100% down	600lm/ft	67%	99lm/W
	8' linear		48W	4800lm				
e <sup>2+</sup> LED	4' linear	30K, 35K, 40K	36W	3200lm	100% down	800lm/ft	67%	93lm/W
	8' linear		72W	6400lm				

Patterns top view

LINEAR



A	FIXTURES	CODE
48"	1 × 4' linear	0 4 F T
96"	1 × 8' linear	0 8 F T
144"	3 × 4' linear	1 2 F T

L-SHAPE OUTER

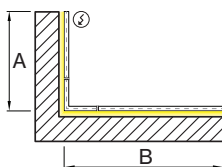

A / B	FIXTURES	CODE
48" / 48"	2 × 2' linear + 1 × 2' × 2' corner	0 4 X 0 4 F T
48" / 96"	1 × 2' linear + 1 × 6' linear + 1 × 2' × 2' corner	0 4 X 0 8 F T
96" / 96"	2 × 6' linear + 1 × 2' × 2' corner	0 8 X 0 8 F T

L-SHAPE INNER

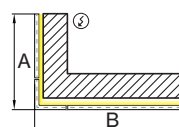

A / B	FIXTURES	CODE
48" / 48"	2 × 2' linear + 1 × 2' × 2' corner	0 4 X 0 4 F T
48" / 96"	1 × 2' linear + 1 × 6' linear + 1 × 2' × 2' corner	0 4 X 0 8 F T
96" / 96"	2 × 6' linear + 1 × 2' × 2' corner	0 8 X 0 8 F T

LIGHT DIRECTION DIAGRAM



